



VDI SAFETY



MICRO

TITAN

TPH

TPS

TPSP

TPF

TPK

TPC

TPR

TPB

TPHC

TPA
TPG

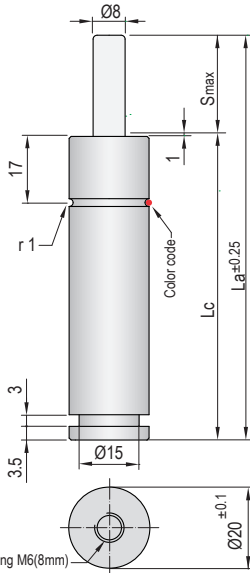

Gas charging M6(8mm)
TPFV3 valve
M6-C adapter

Pressure medium	Nitrogen (N ₂)
Max. charging pressure	175 Bar
Min. charging pressure	25 Bar
Rod seal area	0,50 cm ²
Operating temperature	0°C - 80°C
Force increase by temperature	0,33 %/°C
Max. stem speed	1,6 m/s
Maintenance kit	Kit A20



Maximum strokes / minute (at 20°C)

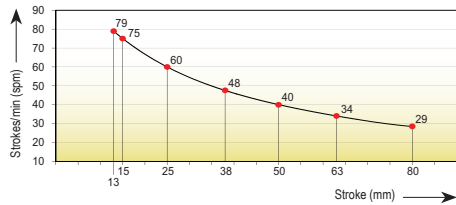

Code	Smax mm	La mm	Lc mm	V l	Kg
TPA 20x13	12,7	79,4	66,7	0,004	0,11
TPA 20x15	15	86	71	0,005	0,12
TPA 20x25	25	104	79	0,007	0,13
TPA 20x38	38	130	92	0,009	0,15
TPA 20x50	50	154	104	0,012	0,16
TPA 20x63	63	180	117	0,014	0,18
TPA 20X80	80	214	134	0,017	0,20

Color code	Fa daN	90% F daN	P Bar
GR (Green)	25 (±5)	≈ 31	50
BL (Blue)	50 (±5)	≈ 61	100
RD (Red)	75 (±5)	≈ 92	150
YW (Yellow)	90 (±5)	≈ 107	175
(Other forces)	13 - 90	≈ 16 - 107	25 - 175

The black color code denotes a different pressure from that which the customer could choose when ordering between the minimum charging pressure and the maximum charging pressure. If not otherwise specified, the gas spring will be supplied in the yellow code version (YW).

How to order

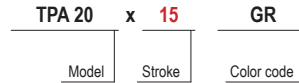

Force/stroke ratio

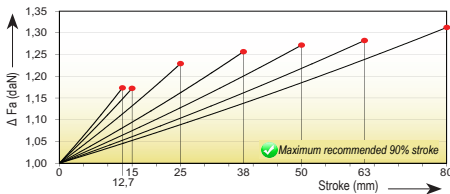

Initial force/charging pressure ratio

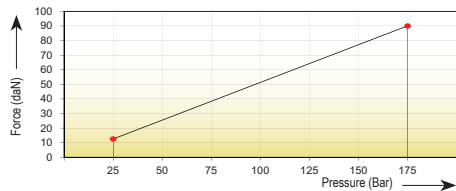

Assembly possibilities



Follow guidelines
Page 287

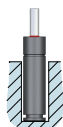

DROP-IN



SCREWS



FP 20